

DO NOT PRINT THIS PAGE

Printing Notes:

Material: 80 GSM Bond Paper or 50# Bond Paper White

Ink: Black

Resolution: 150 DPI or above

Printing method: Offset Printing

Binding: Saddle Stitch

Folded size: 210 x 148 mm (H x W)

*This drawing contains proprietary information and trade secrets of The Furrion Company, Inc.
Unauthorized use or copying is prohibited.*

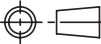
METRIC [INCH]						
METRIC [INCH]		V4.0	26-Feb-18	Updated per outsourced Tech.Writer's comments.	Streng Shi	XX
		V3.0	05-Dec-17	Updated the copyright.	Streng Shi	XX
		V2.0	21-Sep-17	Update the logo & copyright, and add registered trademark	Sally Peng	XX
VOLUME	cm ³	V1.0	22-Dec-16	NEW	Streng Shi	XX
MASS	grams	REV.	DATE	MODIFICATIONS	NAME	ECN NO.
DENSITY	g/cm ³	MATERIAL: SEE NOTES			The Furrion Company, Inc.	
GENERAL TOLERANCES EXCEPT AS NOTED 0 TO 6mm = ±0.1 >6 TO 30mm = ±0.2 >30 TO 80mm = ±0.3 >80 TO 180mm = ±0.4 >180mm = ±0.5 ANGULAR = ±3°		FINISH SPEC: SEE NOTES			COMPOSITE-NO	SHEET 1 OF 1
SCALE:	DATE:	DRAWN BY:	APPROVED BY:	REVISION:		
1:1	22-Dec-16	Streng Shi	Jason Mak	4.0		
NAME: IM for FEHD19S0A/FEFD22S0A CMAC TV					PART NO. IM-FAV00002	

FURRION

LED HD TV

Owner's Manual

Model: FEHD19S0A / FEFD22S0A



Welcome

Thank you and congratulations for purchasing this Furrion® LED HD TV/DVD COMBO 12V TV. Before placing your new appliance into operation, please read these operating instructions carefully. This instruction manual contains important information for safe use, installation and maintenance of the appliance.

Please keep this instruction manual in a safe place for future reference. This will ensure safe use and reduce the risk of injury to persons. Pass it onto possible new owners of the appliance.



The manufacturer does not accept responsibility for any damages that may arise due to non-observation of these instructions.

If you have any further questions regarding our products, please contact us at [**support@furrion.com**](mailto:support@furrion.com)

Contents

Welcome	1
Contents	2
Safety Warnings	3
Important Safety Instructions	3
Safety Precautions	6
Function Overview	8
Control Panel	8
Rear Panel	9
Remote Control	10
About Your LED HD TV	12
Features	12
Power Source	12
Before Operation	13
What's in the Box	13
Preparation of your Remote Control	13
Getting Started	14
Change the Setup Settings	15
Change the Picture Settings	18
Change the Sound Settings	19
Change the Time Setting	21
Change the Lock Settings	22
Change the Channel Settings	24
Change the PC Settings	25
DVD Player Setup	26
USB Mode	27
DVD Player Controls	28
DVD Player Playback	29
Loading a Disc	29
DVD/VCD/SVCD Playback	29
Video/Audio/Picture Playback	29
DVD Player Playback	30
Troubleshooting	31
Specifications	32

Safety Warnings

	CAUTION RISK OF ELECTRIC SHOCK DO NOT OPEN	
CAUTION: TO REDUCE THE RISK OF ELECTRIC SHOCK, DO NOT REMOVE COVER (OR BACK). NO USER-SERVICEABLE PARTS INSIDE. REFER SERVICING TO QUALIFIED SERVICE PERSONNEL.		

 This 'bolt of lightning' indicates uninsulated material within your unit may cause an electrical shock. For the safety of everyone in your household, please do not remove product covering.

 The 'exclamation mark' calls attention to features for which you should read the enclosed literature closely to prevent operating and maintenance problems.

WARNING: To reduce the risk of fire or electric shock, this apparatus should not be exposed to rain or moisture and objects filled with liquids, such as vases, should not be placed on this apparatus.

CAUTION: To prevent electric shock, fully insert the plug. (For regions with polarized plugs: To prevent electric shock, match wide blade to wide slot.)

Important Safety Instructions

1. Read these instructions.
2. Keep these instructions.
3. Heed all warnings.
4. Follow all instructions.
5. Do not use this apparatus near water.
6. Clean only with a dry cloth.
7. Do not block any of the ventilation openings. Install in accordance with the manufacturers instructions.
8. Do not install near any heat sources such as radiators, heat registers, stoves, or other apparatus (including amplifiers) that produce heat.

9. Do not defeat the safety purpose of the polarized or grounding-type plug. A polarized plug has two blades with one wider than the other.

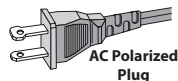

A grounding type plug has two blades and a third grounding prong. The wide blade or the third prong are provided for your safety. When the provided plug does not fit into your outlet, consult an electrician for replacement of the obsolete outlet.

10. Protect the power cord from being walked on or pinched, particularly at plugs, convenience receptacles, and the point where they exit from the apparatus.
11. Only use attachments/accessories specified by the manufacturer.
12. Use only with a cart, stand, tripod, bracket, or table specified by the manufacturer or sold with the apparatus. When a cart is used, use caution when moving the cart/apparatus combination to avoid injury from tip-over.



13. Unplug this apparatus during lightning storms or when unused for long periods of time.
14. Refer all servicing to qualified service personnel. Servicing is required when the apparatus has been damaged in any way, such as if the power-supply cord or plug is damaged, liquid has been spilled or objects have fallen into the apparatus, or when the apparatus has been exposed to rain or moisture, does not operate normally, or has been dropped.
15. Apparatus should not be exposed to dripping or splashing, and objects filled with liquids, such as vases, should not be placed on the apparatus.

Safety Warnings

- An outside antenna system should not be located in the vicinity of overhead power lines or other electric light or power circuits, or where it can fall into such power lines or circuits. When installing an outside antenna system, extreme care should be taken to keep from touching such power lines or circuits as contact with them might be fatal.
- Do not overload wall outlets, extension cords, or integral convenience receptacles as this can result in a risk of fire or electric shock.
- Never push objects of any kind into this product through openings as they may touch dangerous voltage points or short-out parts that could result in a fire or electric shock. Never spill liquid of any kind on the product.
- If an outside antenna or cable system is connected to the unit, be sure the antenna or cable system is grounded to provide some protection against voltage surges and built-up static charges, Section 810 of the National Electrical Code, ANSI/NFPA 70, provides information with respect to proper grounding of the mast and supporting structure, grounding of the lead-in wire to an antenna discharge unit, size of grounding conductors, location of antenna discharge unit, connection to grounding electrodes, and requirements for the grounding electrode.
- When replacement parts are required, be sure the service technician uses replacement parts specified by the manufacturer or those that have the same characteristics as the original part. Unauthorized substitutions may result in fire, electric shock or other hazards.
- Upon completion of any service or repairs to this unit, ask the service technician to perform safety checks to determine that the unit is in proper operating condition.
- When you connect the product to other equipment, turn off the power and unplug all of the equipment from the wall outlet. Failure to do so may cause an electric shock and serious personal injury. Read the owner's manual of the other equipment carefully and follow the instructions when making any connections.
- Sudden high volume sound may cause hearing or speaker damage. When you use headphones, (if the unit is equipped with a headphone jack) keep the volume at a moderate level. If you use headphones continuously with high volume sound, it may cause hearing damage.
- Do not allow the product to output distorted sound for an extended period of time. It may cause speaker overheating and fire.
- This reminder is provided to call the cable TV system installer's attention to Article 820-40 of the NEC that provides guidelines for proper grounding and, in particular, specifies that the cable ground shall be connected to the grounding system of the building, as close to the point of cable entry as practical.
- The socket-outlet must be installed near the unit and easily accessible.
- The mains plug is used as the disconnect and shall remain readily operable.

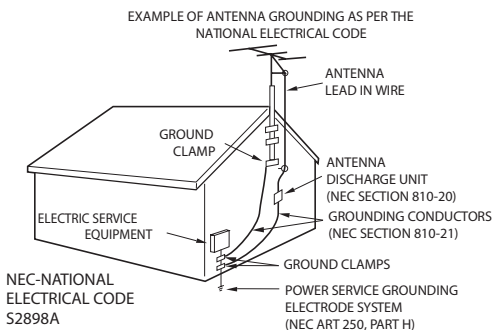

Safety Warnings

CONDENSATION

Moisture will form in the operating section of the unit if the unit is brought from cool surroundings into a warm room or if the temperature of the room rises suddenly. When this happens, unit's performance will be impaired. To prevent this, let the unit stand in its new surroundings for about an hour before switching it on, or make sure that the room temperature rises gradually. Condensation may also form during the summer if the unit is exposed to the breeze from an air conditioner. In such cases, change the location of the unit.

HOW TO HANDLE THE LCD PANEL

- Do not press hard or jolt the LCD panel. It may cause the LCD panel glass to break and injury may occur.
- If the LCD panel is broken, make absolutely sure that you do not touch the liquid in the panel. This may cause skin inflammation. If the liquid gets in your mouth, immediately gargle and consult with your doctor. Also, if the liquid gets in your eyes or touches your skin, consult with your doctor after rinsing for at least 15 minutes or longer in clean water.

Possible Adverse Effects on LCD Panel: If a fixed (non-moving) pattern remains on the LCD Panel for long periods of time, the image can become permanently engrained in the LCD Panel and cause subtle but permanent ghost images. This type of damage is NOT COVERED BY YOUR WARRANTY. Never leave your LCD Panel on for long periods of time while it is displaying the following formats or images:

- Fixed Images, such as stock tickers, video game patterns, TV station logos, and websites.
- Special Formats that do not use the entire screen. For example, viewing letterbox style (16:9) media on a normal (4:3) display (black bars at top and bottom of screen); or viewing normal style (4:3) media on a wide screen (16:9) display (black bars on left and right sides of screen).

The following symptoms are not signs of malfunction but technical limitation. Therefore we disclaim any responsibility for these symptoms.

- LCD Panels are manufactured using an extremely high level of precision technology, however sometimes parts of the screen may be missing picture elements or have luminous spots. This is not a sign of a malfunction.
- Do not install the LCD Panel near electronic equipment that produces electromagnetic waves. Some equipment placed too near this unit may cause interference.
- Effect on infrared devices – There may be interference while using infrared devices such as infrared cordless headphones.

Power source: This LED television is designed to operate on 120 volts 60 Hz, AC current. Insert the power cord into a 120 volt 60 Hz outlet. To prevent electric shock, do not use the LED television's (polarized) plug with an extension cord, receptacle, or other outlet unless the blades and ground terminal can be fully inserted to prevent blade exposure. Never connect the LED television to 50 Hz, direct current, or anything other than the specified voltage.

Warning: To reduce the risk of fire or electric shock, do not expose this apparatus to rain or moisture.

Caution: Never remove the back cover of the LED television as this can expose you to very high voltages and other hazards. If the television does not operate properly, unplug the LED television and call your authorized dealer or service center.

Adjust only those controls that are covered in the instructions, as improper changes or modifications not expressly approved by Furrion could void the user's warranty.

Safety Warnings

Declaration of Conformity

WARNING: This equipment has been tested and found to comply with the limits for a Class B digital device, pursuant to Part 15 of the FCC Rules. These limits are designed to provide reasonable protection against harmful interference in a residential installation. This equipment generates, uses and can radiate radio frequency energy and, if not installed and used in accordance with the instructions, may cause harmful interference to radio communications. However, there is no guarantee that interference will not occur in a particular installation. If this equipment does cause harmful interference to radio or television reception, which can be determined by turning the equipment off and on, the user is encouraged to try to correct the interference by one or more of the following measures:

- Reorient or relocate the receiving antenna.
- Increase the separation between the equipment and receiver.
- Connect the equipment to an outlet on a circuit different from that to which the receiver is connected.
- Consult the dealer or an experienced radio/TV technician for help.

CAUTION: Changes or modifications not expressly approved by the party responsible for compliance with the FCC Rules could void the user's authority to operate this equipment.

Safety Precautions

WARNING: Never place a television set in an unstable location. A television set may fall, causing serious personal injury or death. Many injuries, particularly to children, can be avoided by taking simple precautions such as:

- Using cabinets or stands recommended by the manufacturer of the television set.
- Only using furniture that can safely support the television set.
- Ensuring the television set is not overhanging the edge of the supporting furniture.

- Not placing the television set on tall furniture (for example, cupboards or bookcases) without anchoring both the furniture and the television set to a suitable support.
- Not placing the television set on cloth or other materials that may be located between the television set and supporting furniture.
- Educating children about the dangers of climbing on furniture to reach the television set or its controls.

If your existing television set is being retained and relocated, the same considerations as above should be applied.

The unit emits heat when in operation. Do not place any covers or blankets on the unit, this may cause overheating. Do not block ventilation holes, or set up near radiators. Do not place in direct sunlight. When placing on a shelf leave 4 inches (10 cm) free space around the entire unit.

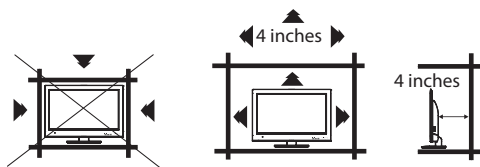

Safety Warnings

Notes when mounting the LED TV on the wall

If the unit is to be mounted on the wall, contact the retailer where you purchased the LED TV for advice, and have the equipment professionally installed. Incomplete or improper installation may cause injury to you, and/or damage to the LED TV.

Please refer to the table below to ensure the correct size VESA mount is used with the TV

VESA MOUNTING PATTERN				
TV Model	Width mm	Height mm	Screw Size	Quantity
FEHD19S0A	100	100	PM4*8mm	4
FEFD22S0A	100	100	PM4*8mm	4

Notice for TV Cabinet

If the unit is to be mounted on a cabinet smaller than length of the unit, it could result in an unstable location and the unit may tumble over, making a risk of personal, possibly fatal injury. Also, this would damage the product seriously. Accordingly, Furriion accepts no responsibility or liability for any injuries or property damage resulting from the improper installation.

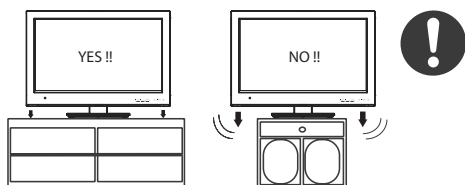

WARNING:

- Do not use this TV with wall mounts that allow the TV to tilt vertically. Vertical tilting wall mounts may cause structural damage to the TV.
- Use ONLY fixed or horizontal swiveling wall mounts with this TV.

Function Overview

Control Panel

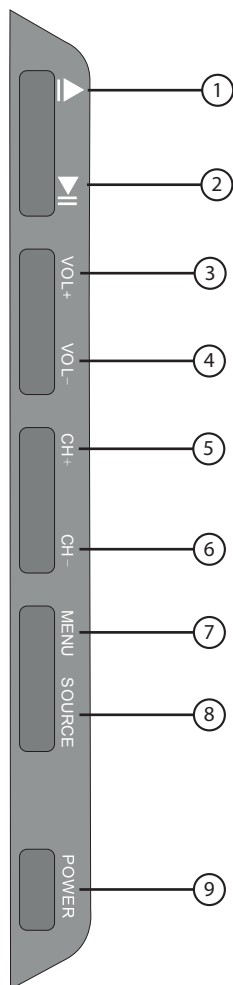

①	▶	Press to eject the disc
②	▶	Press to start/pause the disc playback
③	VOL+	Press to increase the volume
④	VOL-	Press to decrease the volume
⑤	CH+	Press to skip to the next channel
⑥	CH-	Press to skip to the previous channel
⑦	MENU	Press to enter the main menu
⑧	SOURCE	Press to select the input source
⑨	POWER	Press to switch the TV on/off

* Please note that the button layout of the controls may vary from model to model.

Function Overview

Rear Panel

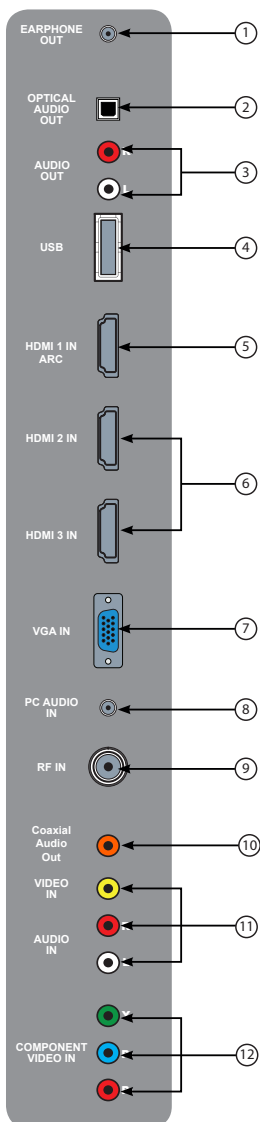

①	EARPHONE OUT	Connects to 3-conductor (TRS) phone connector of earphone, compatibility of earphone with 4-conductor (TRRS) phone connector is not guaranteed
②	OPTICAL AUDIO OUT	Connects to the OPTICAL AUDIO IN port of an audio device.
③	AUDIO OUT	Connects to the AUDIO IN ports of an audio device
④	USB	USB Port, view pictures and listen to MP3s via a compatible USB stick
⑤	HDMI 1 IN ARC	Connects to the HDMI OUT port of a DVD Player, Games Console, Cable Box or other HDMI device. ARC Audio Return Channel When connected with a HDMI 1.4 cable to an ARC compatible audio system, the TV links with the device to give extra audio functionality Please see page 13
⑥	HDMI 2 IN	Connects to the HDMI OUT port of a DVD Player, Games Console, Cable Box or other HDMI device.
	HDMI 3 IN	CEC Consumer Electronics Control When connected to the CEC compatible Furrion Entertainment Systems or other CEC Compatible devices, the TV links with the system to give extra functionality. Please see page 23
⑦	VGA IN	Connects to the VGA OUT port of a PC to use the TV as a monitor
⑧	PC AUDIO IN	Connects to the AUDIO OUT port of a PC
⑨	RF IN	Connects to the ANTENNA, CABLE, or CABLE BOX
⑩	COAXIAL AUDIO OUT	Connects to the COAXIAL AUDIO IN port of an audio device
⑪	VIDEO IN	Connects to the COMPOSITE VIDEO/ AUDIO OUT ports of a DVD Player, Cable Box or other compatible device
	AUDIO IN	
⑫	COMPONENT VIDEO IN	Connect to the COMPONENT VIDEO OUT ports of a DVD Player, Cable Box or other compatible device

* The configuration of the connection ports may vary from model to model.

Function Overview



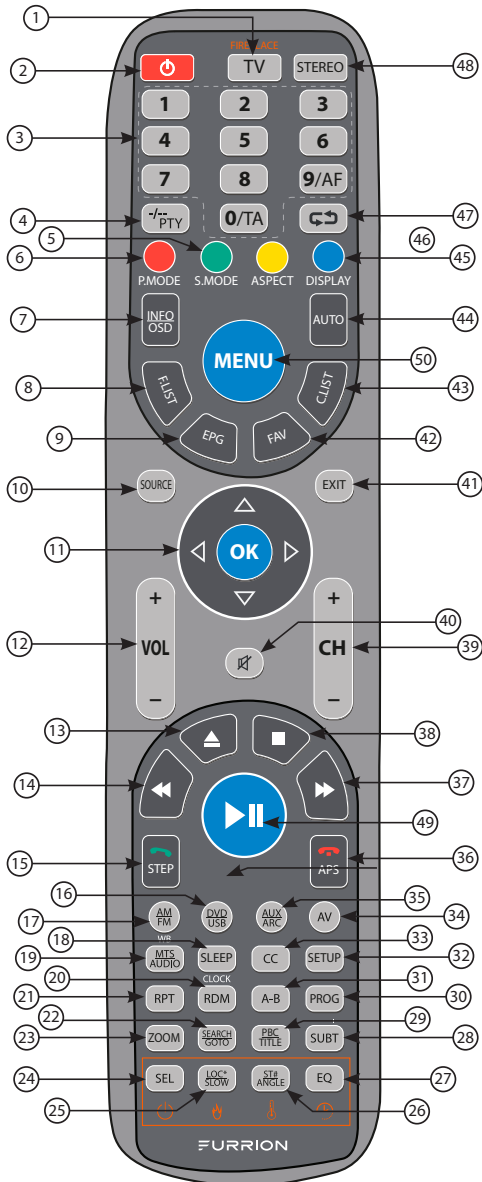



Remote Control



No.	Button	Function
①	TV	Switches to TV mode
	TV/ FIREPLACE	Selects Furrion Fireplace remote control functions. * Please refer to your Furrion Fireplace manual for more information.
②		Press to turn the TV/Entertainment System on/off
③	NUMBER BUTTONS	Enters numbers or select channels
④	-/- PTY	Toggles between single & double digit input
⑤	S.MODE	Cycles through sound modes
⑥	P.MODE	Cycles through picture modes
⑦	INFO/OSD	Under TV mode, press to display information on the selected TV channel Under Stereo mode, press to display DVD playback status
⑧	F.LIST	Displays the favorites list
⑨	EPG	Displays the program guide
⑩	SOURCE	Cycles through input sources
⑪	NAVIGATION BUTTONS	Confirms selections
⑫	VOL+/-	Increases/decreases volume
⑬		Ejects DVD/ CD
⑭		During playback, press to select the previous track/chapter. Press and hold to rewind. Automatic or Manual tuning in radio mode
⑮	STEP	Press to forward frame by frame during DVD/VCD playback. Dial or accept a call (when the system is connected to a cell phone)
⑯	DVD/USB	Selects DVD/USB
⑰	AM/FM	Selects AM/FM/WB Radio

Function Overview

No.	Button	Function
18	SLEEP/ CLOCK	Sets the sleep timer
19	MTS/AUDIO	Cycles through MTS sound modes
20	RDM	Toggles random playback mode on & off
21	RPT	Press to select repeat playback modes.
22	SEARCH/ GOTO	Jumps to a specific time on a DVD/ VCD/MP3/WMA or CD
23	ZOOM	Press to enlarge screen images
24	SEL	Toggles between Volume, Bass, Treble & Balance; Hours & Minutes for adjusting
25	LOC*/SLOW	Toggles radio reception strength. Presses to start slow motion playback.
26	ST#/ANGLE	Toggles Stereo & Mono sound/ switches viewing angles on compatible media.
27	EQ	Toggles the sound mode Cinema, Rock, Classic & Flat
28	SUBT	Press to display subtitles on compatible media. Repeatedly press to cycle through subtitle options.
29	PBC/TITLE	Displays DVD/VCD Title lists/ Toggles PBC (Play Back Control) on & off
30	PROG	Uses to start the programmed playback function
31	A-B	Press to start the A-B repeat function (playback loop of a segment of track)
32	SETUP	Enters the Setup menu for the entertainment system
33	CC	Toggles Closed Captions On & Off
34	AV	Selects AV Mode
35	AUX/ARC	Selects AUX/ ARC Mode

No.	Button	Function
36	 APS	Press to scan radio stations: A brief press searches through each stored station. Press & hold to scan and store the 6 strongest stations. End or reject a call (when the system is connected to a cell phone)
37		During playback, press to select the next track/ chapter. Press and hold to fast forward. Automatic or Manual tuning in radio mode
38		Stops playback
39	CH+/-	Channel Up/Down
40		Toggles audio On or Off
41	EXIT	Exits the current menu
42	FAV	Displays the channel list
43	C.LIST	Displays the channel list
44	AUTO	Automatically adjusts the picture in PC mode
45	DISPLAY	Toggles on screen on the selected source On & Off
46	ASPECT	Cycles through available display aspect ratios
47		Toggles between the current and previous channel
48	STEREO	Switches to Stereo mode
49		Starts, Pauses or restarts playback
50	MENU	Enters the main menu

About Your LED HD TV

Features

Integrated Digital Tuner - You can view digital broadcasts without using a Digital TV Set-Top Box.

Closed Caption Decoder With Full Text Mode - Displays text captions or full screen text on the screen for hearing impaired viewers.

Picture Adjustments Using The Remote Control - The On-Screen display allows precise remote control adjustment of BRIGHTNESS, CONTRAST, COLOR, TINT and SHARPNESS.

Programmable TV Sleep Timer - Operable from the remote control, the TV can be programmed for up to 240 minutes to turn off automatically.

On-Screen 3 Language Display - You can select one of 3 languages, English, Spanish or French for on-screen programming.

HDMI/Component Video Jacks - A VCR, DVD player, satellite receiver or other audio/video component can be connected to this unit.

Power Source

NOTE:

- Please make sure to insert the cord securely at both the LED TV and the wall outlet.
- The AC Cord has a polarized type AC line plug. If the supplied AC cord does not match your AC outlet, contact a qualified electrician.
- Furrion 12V TVs have a special power board built-in to protect the TV from power spikes, power ripples and low voltage conditions normally present on a 12V power system. Furrion's 12V TVs are the only TVs on the market with an extended 10 – 30 V operating range for ultimate TV PCB protection.
- 12 V or 24 V DC power sources with interference can create lines or snowy picture, to combat this Furrion TVs have added a special anti-interference filter which removes all power ripples and interference giving a clear picture. Furrion TVs can be used directly with 12 V or 24 V DC power systems and also with 110 V or 220 V AC system by using the external power adapter included. These TVs are specially designed to be used in Trucks, RV's, Boats and Cabins with 12 V or 24 V DC power systems.

WARNING:

- DO NOT CONNECT THIS UNIT TO THE POWER USING ANY DEVICE OTHER THAN THE SUPPLIED AC CORD. THIS COULD CAUSE FIRE, ELECTRICAL SHOCK, OR DAMAGE.
- DO NOT USE WITH A VOLTAGE OTHER THAN THE POWER VOLTAGE SPECIFIED. THIS COULD CAUSE FIRE, ELECTRICAL SHOCK, OR DAMAGE.

CAUTION:

- WHEN THIS UNIT IS NOT USED FOR A LONG TIME, (E.G., AWAY ON A TRIP) IN THE INTEREST OF SAFETY, BE SURE TO UNPLUG IT FROM THE AC OUTLET.
- DO NOT PLUG/UNPLUG THE AC CORD WHEN YOUR HANDS ARE WET. THIS MAY CAUSE ELECTRICAL SHOCK.
- IF YOU NEED TO REPLACE THE SUPPLIED AC ADAPTER OR AC CORD, THE SPECIFIED ONE IS RECOMMENDED. CONTACT THE DEALER THAT YOU PURCHASED THE UNIT FROM.

Before Operation

What's in the Box

Thanks for purchasing this Furrion LED HD TV. This manual will help you set up and begin using your TV. Please read this manual thoroughly and keep this manual in a safe place for future reference.

First, check the contents of your box with the parts checklist below:

- 12V Cigarette Adapter
- Unimote
- 110 V/220 V Power Adapter
- Instruction Manual
- Wall-mount screws
- Bottom Mount Stand

Now you can get started!

Preparation of your Remote Control

BATTERY INSTALLATION

1. Open battery compartment cover.

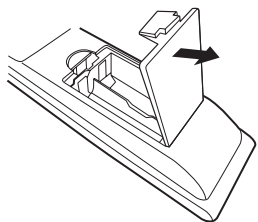

2. Install two AAA batteries.

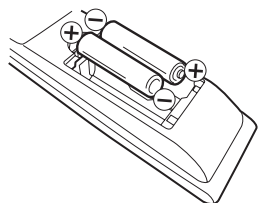

3. Close the cover of the battery compartment.

NOTE: Use two "AAA" size batteries. The batteries may last approximately one year depending on

how much the remote control is used. For best performance, it is recommended that batteries should be replaced on a yearly basis, or when the remote operation becomes erratic. Do not mix old and new batteries or different types.

BATTERY PRECAUTIONS

These precautions should be followed when using batteries in this device:

- Use only the size and type of batteries specified.
- Be sure to follow the correct polarity when installing the batteries as indicated in the battery compartment. Reversed batteries may cause damage to the device.
- Do not mix different types of batteries together (e.g. Alkaline and Carbon-zinc) or old batteries with fresh ones.
- If the device is not to be used for a long period of time, remove the batteries to prevent damage or injury from possible battery leakage.
- Do not try to recharge batteries not intended to be recharged; they can overheat and rupture. (Follow battery manufacturer's directions.)
- Please use caution when inserting batteries to avoid battery damage. If the spring terminal in the remote control remains in contact with a side of a damaged battery it can cause a short circuit. Never use damaged batteries as they can become very hot and are dangerous.

Getting Started

The **Setup Wizard** window appears the first time you turned on the TV. It will assist you to configure the TV and scan for available channels. **IMPORTANT:** Make sure the antenna or cable TV system connection is made.

1. Press **POWER** button on the TV control panel or  button on the remote control to switch on the TV. The power indicator will change to green. The **Setup Wizard** window appears on the screen. **NOTE:** It may take a few seconds before the **Setup Wizard** window appears on the screen.
2. Use **▲** or **▼** keys to check **Home Mode (Energy Saving)** or **Retail Mode**. Press **OK** to enter the next menu.



3. Use **▲** or **▼** keys to check **Yes** or **No**. Press **OK** to enter the next menu or press **MENU** to return to the previous menu.

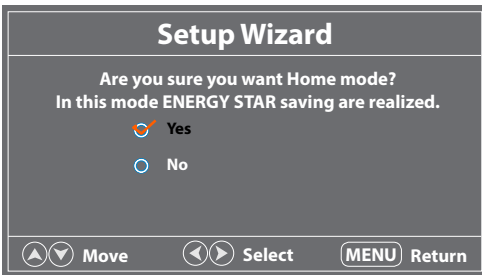

4. Use **▲ / ▼ / ◀ / ▶** keys to navigate and select your desired settings.



Setup Wizard	
Menu Language	Use ▲ or ▼ keys to highlight Menu Language , then press ◀ or ▶ to select English, French or Spanish .
Air/Cable	Use ▲ or ▼ keys to highlight Air/Cable , then press ◀ or ▶ to select Air or Cable .
Cable System	Use ▲ or ▼ keys to highlight Cable System , then press ◀ or ▶ to select Auto, STD, IRC or HRC . NOTE: Only adjustable after set "Air/Cable" as "Cable" mode.
Auto Scan	Use ▲ or ▼ keys to highlight Auto Scan , then press OK or ▶ to start memorizing all the channels available in your area.

NOTE: You may press **EXIT** at any time to exit the menu.

Change Settings

Change the Setup Settings

1. Press **MENU** button, the setup window will appear on the screen.
2. Use **◀** or **▶** keys to highlight **Setup** mode.
3. Use **▲** or **▼** to highlight the item you would like to reset, then press **◀** or **▶** to select the settings.
4. Press **MENU** to return to the previous menu or press **EXIT** at any time to exit the setting.

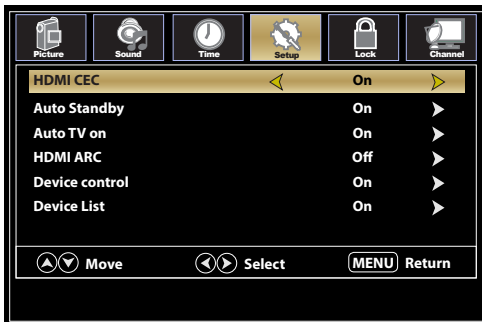
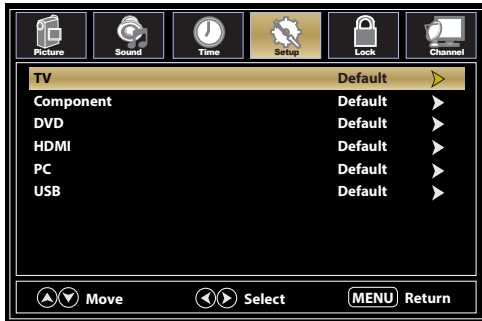
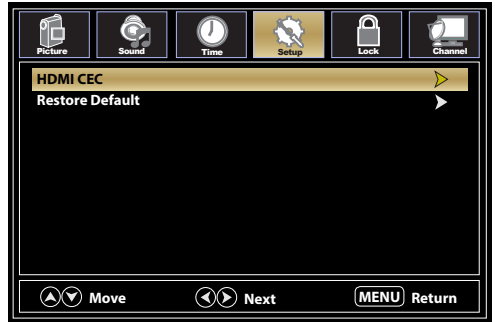

Change Settings

Setup Menu

Menu Language	Selects the menu language	Press ◀ or ▶ to select English, French or Spanish.	
Transparency	Controls the transparency level of the menu	Press ◀ or ▶ to select Off or On	
Zoom Mode	Set the picture proportion	Press ◀ or ▶ to select Wide, Normal, Auto, Panorama, Just Scan, Zoom2 or Zoom.	
Noise Reduction	Reduce the roughness of the picture.	Press ◀ or ▶ to select Middle, Strong, Off or Weak.	
Advanced	Controls the PC settings. *Only available after a PC connected	See page 25.	
Source Label	Allows labeling of input sources	TV	Press ◀ or ▶ to select Custom, Default, Antenna, Cable, Satellite, DTV, DVD, Blu-ray, HD-DVD, XBOX, Wii, PS3, Game, Computer, VCR or DV
		Component	
		DVD	
		HDMI	
		PC	
		USB	

Change Settings

Setup Menu

Closed Caption	Configure Closed Caption functions	CC Mode	Press ◀ or ▶ to select Off , On or CC On Mute
		Basic Selection	Press ◀ or ▶ to select CC1 , CC2 , CC3 , CC4 , Text 1 , Text 2 , Text 3 or Text 4
		Advanced	Press ◀ or ▶ to select Service 1 , Service 2 , Service 3 , Service 4 , Service 5 or Service 6
		Mode	Press ◀ or ▶ to select Default or Custom
		Font Style	Press ◀ or ▶ to select Default , Font 0 , Font 1 , Font 2 , Font 3 , Font 4 , Font 5 , Font 6 or Font 7
		Font Size	Press ◀ or ▶ to select Default , Normal , Large or Small
		Font Edge Style	Press ◀ or ▶ to select Default , None , Raised , Depressed , Uniform , Left Shadow or Right Shadow
		Font Edge Color	Press ◀ or ▶ to select Default , Black , White , Red , Green , Blue , Yellow , Magenta or Cyan
		FG Color	Press ◀ or ▶ to select Default , White , Red , Green , Blue , Yellow , Magenta or Cyan
		BG Color	Press ◀ or ▶ to select Default , Cyan , Magenta , Yellow , Blue , Green , Red or Black
		FG Opacity	Press ◀ or ▶ to select Default , Solid , Flashing , Translucent or Transparency
		BG Opacity	Press ◀ or ▶ to select Default , Solid , Flashing , Translucent or Transparency
DLC	Controls the picture contrast	Press ◀ or ▶ to select Off or On	
Setup Wizard	Starts the Setup Wizard	See Page 14.	
HDMI CEC	Configure CEC functions	HDMI CEC	Press ◀ or ▶ to select Off or On
		Auto Standby	Press ◀ or ▶ to select Off or On
		Auto TV on	Press ◀ or ▶ to select Off or On
		HDMI ARC	Press ◀ or ▶ to select Off or On
		Device Control	Press ◀ or ▶ to select Off or On
		Device List	Press OK or ▶ to enter and start searching for available HDMI devices
Restore Default	Reset to factory default settings	Press ◀ or ▶ to select Yes or No	

Change Settings

Change the Picture Settings

1. Press **MENU** button, the setup window will appear on the screen.
2. Use ◀ or ▶ keys to highlight **Picture** mode.
3. Use ▲ or ▼ to highlight the item you would like to reset, then press ◀ or ▶ to select the settings.
4. Press **MENU** to return to the previous menu or press **EXIT** at any time to exit the setting.

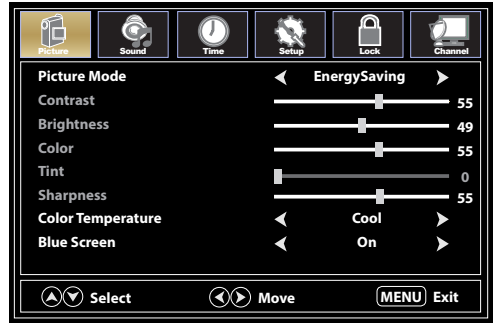

Picture Menu		
Picture Mode	Selects the display mode	Press ◀ or ▶ to select EnergySaving, User, Dynamic, Standard or Mild
Contrast	Controls the contrast level of the picture	Press ◀ or ▶ to change the contrast to desired level * Only adjustable after set "Picture Mode" as "User" mode
Brightness	Controls the brightness level of the picture	Press ◀ or ▶ to change the brightness to desired level * Only adjustable after set "Picture Mode" as "User" mode
Color	Controls the color level of the picture	Press ◀ or ▶ to change the color to desired level * Only adjustable after set "Picture Mode" as "User" mode
Tint	Controls picture tint	Press ◀ or ▶ to change the tint to desired level * Only available under NTSC mode
Sharpness	Controls the sharpness of the picture	Press ◀ or ▶ to change the sharpness to desired level * Only adjustable after set "Picture Mode" as "User" mode
Color Temperature	Selects the color mode	Press ◀ or ▶ to select Cool, Medium or Warm
Blue Screen	Change the screen to blue if no signal input	Press ◀ or ▶ to set as On or Off

Change Settings

Change the Sound Settings

1. Press **MENU** button, the setup window will appear on the screen.
2. Use **◀** or **▶** keys to highlight **Audio** mode.
3. Use **▲** or **▼** to highlight the item you would like to reset, then press **◀** or **▶** to select the settings.
4. Press **MENU** to return to the previous menu or press **EXIT** at any time to exit the setting.

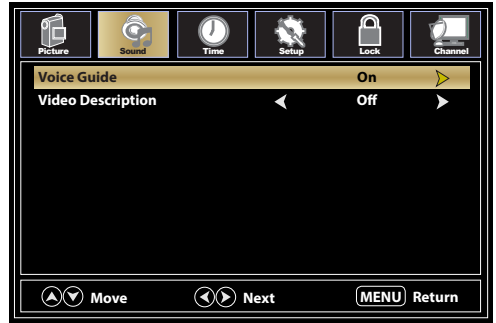
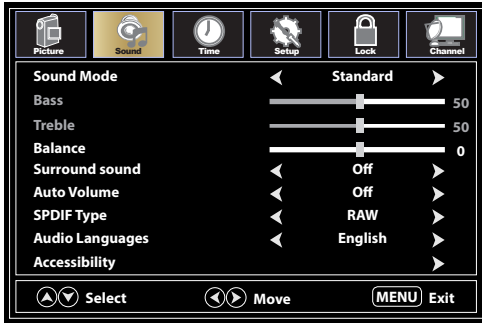

Change Settings

Sound Menu

Sound Mode	Select the sound mode	Press ◀ or ▶ to select Standard, Music, Movie or User mode		
Bass	Control the bass level	Press ◀ or ▶ to change to desired level		
Treble	Control the treble level	Press ◀ or ▶ to change to desired level		
Balance	Control the balance level	Press ◀ or ▶ to change to desired level		
Surround Sound	Control the surround function	Press ◀ or ▶ to set as On or Off		
Auto Volume	Control the sound output	Press ◀ or ▶ to set as On or Off		
SPDIF Type	Select the SPDIF sound mode	Press ◀ or ▶ to select RAW, PCM or Off		
Audio Languages	Select the menu language	Press ◀ or ▶ to select English, French or Spanish		
Accessibility	Control the Voice Guide functions	Voice Guide	Voice Guide	Press ◀ or ▶ to set as On or Off
			Volume	Press ◀ or ▶ to select Weak, Middle or Strong * Only available after Voice Guide was set as On mode
			Speed	Press ◀ or ▶ to select Weak, Middle or Strong * Only available after Voice Guide was set as On mode
			Pitch	Press ◀ or ▶ to select Weak, Middle or Strong * Only available after Voice Guide was set as On mode
		Video Description	Press ◀ or ▶ to set as On or Off	

Change Settings

Change the Time Setting

1. Press **MENU** button, the setup window will appear on the screen.
2. Use **◀** or **▶** keys to highlight **Time** mode.
3. Use **▲** or **▼** to highlight the item you would like to reset, then press **◀** or **▶** to select the settings.
4. Press **MENU** to return to the previous menu or press **EXIT** at any time to exit the setting.



Time Menu

Sleep Timer	Set a period of time of auto switch off the TV	Press ◀ or ▶ to select Off, 5Min, 10Min, 15Min, 30Min, 45Min, 60Min, 90Min, 120Min, 180Min or 240Min
Time Zone	Set the time zone	Press ◀ or ▶ to select Pacific, Alaska, Hawaii, Atlantic, Eastern, Central or Mountain
Daylight Saving Time	Toggle daylight saving	Press ◀ or ▶ to set as On or Off * Only available under TV channel
Time Format	Select the time display format	Press ◀ or ▶ to set as 12-hour or 24-hour
Auto Clock	Sets automatic time adjustment	Press ◀ or ▶ to set as On or Off

Change Settings

Change the Lock Settings

1. Press **MENU** button, the setup window will appear on the screen.
2. Use **◀** or **▶** keys to highlight **Lock** mode.
3. Use **▲** or **▼** keys to highlight **"Enter Password"** and input **"0000"** to enter the setup window.
4. Use **▲** or **▼** to highlight the item you would like to reset, then press **◀** or **▶** to select the settings.
5. Press **MENU** to return to the previous menu or press **EXIT** at any time to exit the setting.

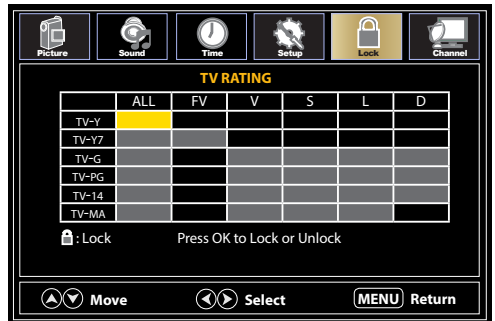
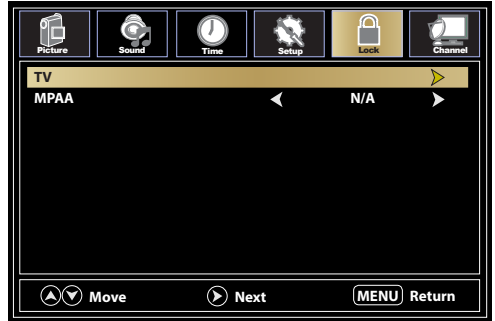

Change Settings

Lock Menu

Enter Password	Password accesses to the lock setup menu	Use the Number Buttons (0~9) to enter the password, the Lock setup window will appear * Default password is 0000 * If you forgot the password, use 8888 to enter any locked menu	
Set Password	Change the user password	Set Password	Use Number buttons (0-9) to enter your password
		Confirm Password	Repeat the password to confirm
System Lock	Password locks the system	Press ◀ or ▶ to set as On or Off	
US	Set parental locks based on US rating system * Only available after System Lock was set as On mode	TV	Set the rating using age level and genre. Refer to Age & Genre table for definition
		MPAA	See US Rating System table
Canada	Set parental locks based on Canadian rating system * Only available after System Lock was set as On mode	Canada English	See Canadian Rating System table
		Canada French	See Canadian Rating System table
RRT Setting	Set parental locks based on Canadian rating system * Only available when the DTV code RRT traffic detected by the system	Canada English	See Canadian Rating System table
		Canada French	See Canadian Rating System table
Reset RRT	Restore to default RRT settings	Press OK or ▶ to enter the sub menu, then press ◀ or ▶ to select Yes or No	
Clear Lock	Restore to default V-chip settings	Press OK or ▶ to enter the sub menu, then press ◀ or ▶ to select Yes or No	

Age

TV-Y	All Children
TV-Y7	7 Years old or above
TV-G	General Advice
TV-PG	Parental Guidance
TV-14	14 Years old or above
TV-MA	17 Years old or above

Genre

ALL	All
D	Dialogue
L	Language
S	Sex
V	Violence
FV	Fantasy Violence

US Rating System

N/A	All Children
G	All Ages
PG	Parental Guidance
PG-13	Parental Guidance below 13
R	Parental Guidance below 17
NC-17	17 Years old or above
X	Adults Only

Canadian Rating System

E	All Children
C	All Ages
C8+	Children below 8
G	General Audience
PG	Parental Guidance
14+	Programming contains themes or content which may not be suitable for viewers under the age of 14
18+	Adult

Change Settings

Change the Channel Settings

1. Press **MENU** button, the setup window will appear on the screen.
2. Use **◀** or **▶** keys to highlight **Channel** mode.
3. Use **▲** or **▼** to highlight the item you would like to reset, then press **◀** or **▶** to select the settings.
4. Press **OK** to confirm your selections or settings and enter the sub menus.
5. Press **MENU** to return to the previous menu or press **EXIT** at any time to exit the setting.

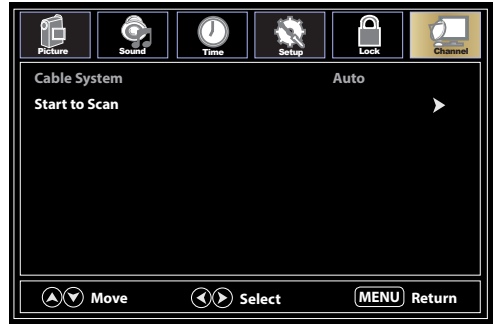

Channel Menu

Air/Cable	Set the reception type	Press ◀ or ▶ to select Air or Cable
Auto Scan	Press ▶ or OK to enter sub menu	Cable System Press ◀ or ▶ to select Auto , STD , IRC or HRC
		Start to Scan Press ▶ or OK to start scan for available channels in your area
Favorite	Add Channels to the favorite list	Press ▲ or ▼ to select a channel, then press ▶ or OK to select or deselect as a favorite
Show/Hide	List available channels	Press ▲ or ▼ to select a channel, then press ▶ or OK to show or hide the channel
Channel No.	Selects the channel number for labeling	Press ◀ or ▶ to select a channel
Channel Label	Allow custom labeling of channels	Press ▲ or ▼ to select a character, press ◀ or ▶ to navigate the characters. (Maximum of 7 characters)
DTV Signal		Blocked

Change Settings

Change the PC Settings

The PC menu is only accessible when a PC is connected to the TV via the VGA connection.

1. Press **MENU** button, the setup window will appear on the screen.
2. Use ◀ or ▶ keys to highlight **Setup** mode.
3. Use ▲ or ▼ to highlight **Advanced**, then press **OK** or ▶ to enter the sub menu.
4. Use ▲ or ▼ to highlight the item you would like to reset, then press ◀ or ▶ to select the settings.
5. Press **MENU** to return to the previous menu or press **EXIT** at any time to exit the setting.

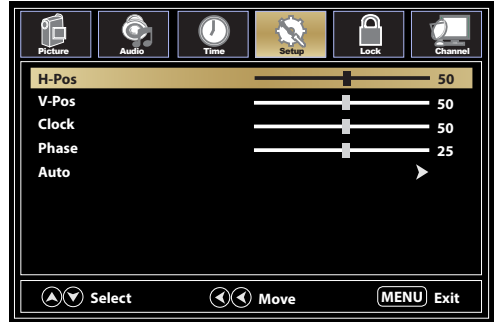

Time Menu

H-Pos	Configures the horizontal position of the TV image	Press ◀ or ▶ to move the screen horizontally
V-Pos	Configures the vertical position of the TV image	Press ◀ or ▶ to move the screen vertically
Clock	Adjusts the pixel Clock (vertical) for a clearer image	Press ◀ or ▶ to adjust
Phase	Adjusts the phase Clock (horizontal) for a clearer image	Press ◀ or ▶ to adjust
Auto	Automatically adjusts the PC settings	Press OK or ▶ to adjust all PC settings automatically

PC MONITOR DISPLAY MODES

Mode	Resolution	Refresh Rate
VGA	640 x 480	60/75 Hz
VGA	720 x 400	70 Hz
VGA	1366 x 768	60Hz
SVGA	800 x 600	60/75 Hz
XGA	1024 x 768	60/70/75 Hz

PC MONITOR DISPLAY MODES

WXGA	1280 x 720	60 Hz
WXGA	1360 x 768	60 Hz
SXGA	1280 x 1024	60 Hz
WXGA+	1440 x 900	60 Hz
WSXGA+	1680 x 1050	60 Hz
FHD	1920 x 1080	60 Hz

* Please note on non FHD TVs some functionality may be limited.

Change Settings

DVD Player Setup

1. During disc playback, press **SETUP** to enter the **General Setup Page**.
2. Use **◀** or **▶** keys to switch among **General Setup Page, Audio Setup Page** and **Preference Page**.
3. Use **▲** or **▼** to highlight the item you would like to reset.
4. Press **▶** to select the switch to the submenu, use **▲** or **▼** to select your desired setting.
5. Press **▶** to return to the previous menu or press **SETUP** at any time to exit the setting.

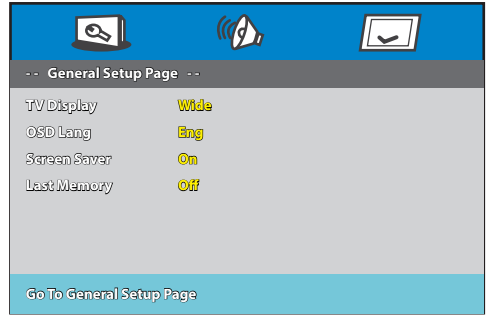

General Setup		
TV Display	Sets the picture ratio	Press ◀ or ▶ to select desired picture ratio
OSD Lang	Sets the OSD display language	Press ◀ or ▶ to select the desired language
Screen Saver	Toggles the screensaver On or Off	Press ◀ or ▶ to set the screensaver On or Off
Last Memory	Toggles the Last Memory option On & Off . Last Memory memorizes when playback is stopped and recalls it when the disc is next played.	Press ◀ or ▶ to set the Last Memory On or Off

Sound Setup		
Downmix	Sets the Audio Downmix mode	Press ◀ or ▶ to select Stereo/ LT/ RT

Preferences		
TV Type	Sets the Output type	Press ◀ or ▶ to select Auto/ PAL/ NTSC
Audio	Sets the preferred DVD audio language	Press ◀ or ▶ to select the desired language
Subtitle	Sets the preferred subtitle language	Press ◀ or ▶ to select the desired language
Disc Menu	Sets the preferred DVD Menu language	Press ◀ or ▶ to select the desired language
Parental	Sets a parental lock on compatible DVD discs	Press ◀ or ▶ to select KID SAF, G, PG, PG 13, PGR, R, NC17 or ADULT
Password	Sets a password for the parental lock	Use the numerical buttons to enter a password
Default	Restores the DVD player settings to it's original settings	Press ◀ or ▶ to select Reset

Change Settings

USB Mode

1. After connecting a flash drive, press **SOURCE** button and select **MEDIA**. Press **OK** or **▶** to enter.
2. Use **◀** or **▶** keys to select to view **Photo** or **Music**. Press **OK** or **▶** to enter.
3. Use **▲** or **▼** to navigate the files or folders on the USB drive.
4. Press **MENU** to return to the previous menu or press **EXIT** at any time to exit the setting.

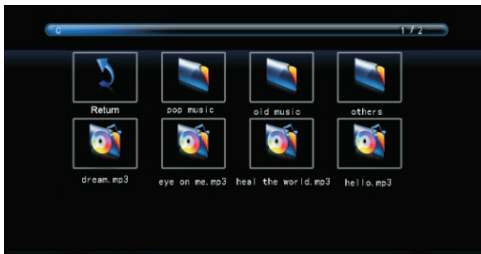
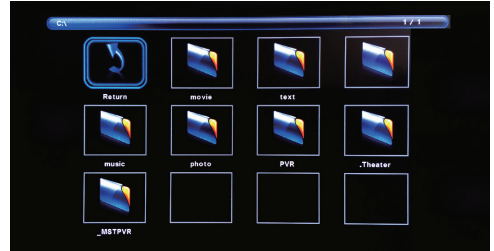

When viewing photos, this photo viewer tool will allow control of the slide show, play music and information on the file.



The photo viewer displays .jpg photo format files

Playback of music is via this music player, which gives playback controls and information on the file.

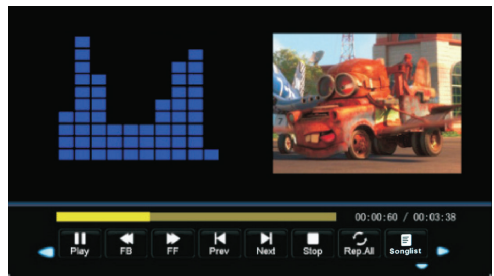

The music player plays MP3 audio format files.

DVD Player Controls

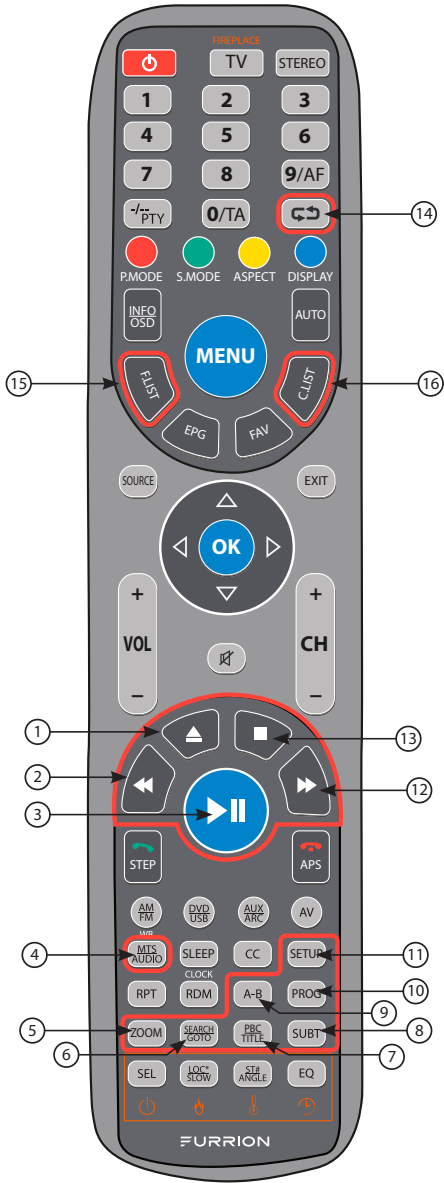

No.	Button	Function
①		Press to eject DVD/CD
②		Press to select the previous track/ chapter during playback
③		Press to start, pause or restart the playback
④	MTS/AUDIO	Change the DVD audio language (if available)
⑤	ZOOM	Press to enlarge the screen images
⑥	SEARCH/ GOTO	Jump to a specific time on a DVD/ VCD/MP3/WMA or CD
⑦	PBC/TITLE	Display DVD/VCD Title
⑧	SUBT	Press to display subtitles on compatible media. Press repeatedly to cycle through subtitle option
⑨	A-B	Press to start the A-B repeat function (playback loop of a segment of track)
⑩	PROG	Used to start the programmed playback function
⑪	SETUP	Press to enter the DVD mode setup menu
⑫		Press to select the next track/ chapter during playback
⑬		Press to stop playback
⑭		Repeat
⑮	F.LIST	Rewind
⑯	C.LIST	Fast forward

DVD Player Playback

Loading a Disc

Before loading a disc into the disc compartment:

- Check and make sure there is no disc in the disc compartment.
 - Make sure the label side of the disc is facing back when inserting a disc.
 - Do not use excessive force when inserting a disc.
1. Press **POWER** button on the control panel or \mathcal{O} on the remote control to switch on the TV.
 2. Press **SOURCE** button on the remote control to display all the available input sources for your TV. Use \blacktriangle or \blacktriangledown to highlight **DVD** mode and press **OK** to enter.
 3. Insert a compatible disc into the disc compartment on the right side of the TV.
 4. Depending on the disc format, the playback may automatically start or a menu will appear on screen allowing playback of files.

- Press \blacktriangleleft or \blacktriangleright during playback to skip to the previous or next chapter/track.
- Press **A-B** to start the A-B repeat function. Press once for the desired start point and press again for the end point.
- Press the number buttons **0~9** to select the chapter or track to play.

When playing a DVD

- Press **PBC/SUBTITLE** to display the DVD menu.
- Press **SUBT** to display subtitles on compatible media. Press repeatedly to cycle through subtitle options
- Press **MTS/ AUDIO** to change the audio track/language. Press repeatedly to cycle through available tracks.

When playing a DVD/ VCD/SVCD

- Press **ZOOM** to enlarge the playback display. Press repeatedly to cycle through zoom levels.

Compatible Media

Type	Compatibility
Disc (12 cm Disc Only)	DVD / DVD-R / DVD+R / DVD-RW / DVD+RW VCD / SVCD CD/ CDR / CDRW
Multimedia Format	MP3 / WMA / JPEG / MPEG-1 / MPEG-2 / MPEG-4 DIVX3.xx / DIVX5.xx

Video/Audio/Picture Playback

When a disc with compatible video/ audio/picture files is inserted into the disc compartment, a file navigation menu will appear on the screen.

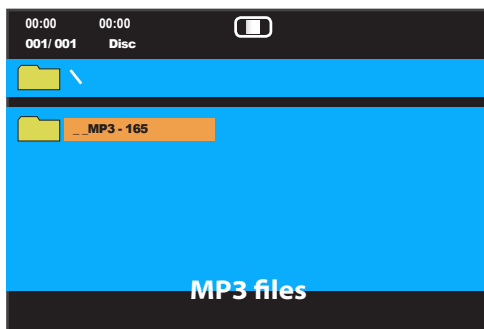

DVD/VCD/SVCD Playback

When playing a DVD/ VCD/ SVCD/ CD

- Press \blacktriangle to eject the disc.
- Press \blacktriangleright to Start, Pause or restart the playback.
- Press \blacksquare to stop the playback.
- Press **F.LIST** or **C.LIST** to rewind or fastforward playback.

DVD Player Playback

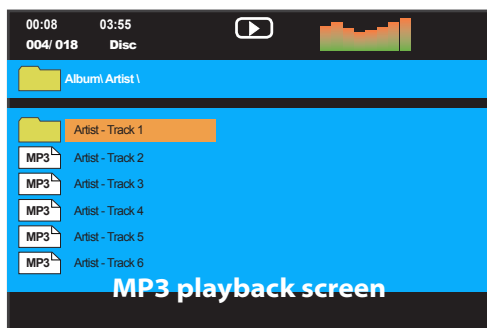
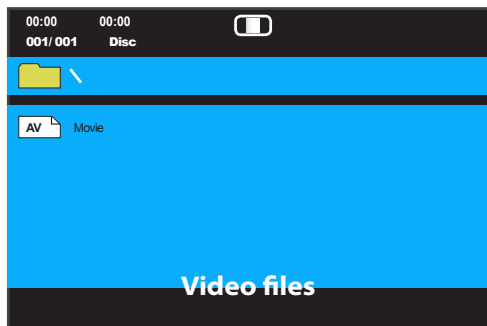

When playing Video/ Audio files from a disc

- Press **▲** to eject the disc.
- Press **▶||** to Start, Pause or restart the playback.
- Press **■** to stop the playback.
- Press **F.LIST** or **C.LIST** to rewind or fastforward playback.
- Press **◀** or **▶** during playback to skip to the previous or next chapter/track.

When viewing a picture

- Press **ZOOM** to enlarge the display. Press repeatedly to cycle through zoom levels.
- Press **◀** or **▶** to display the previous or next picture.

Troubleshooting

Problem	Solution/Issue
TV does not operate	<ul style="list-style-type: none"> ● Make sure the power cord is plugged in. ● Try another AC outlet. ● Power is off, check fuse or circuit breaker. ● Unplug unit for an hour, then plug it back in.
Normal picture, but no sound	<ul style="list-style-type: none"> ● Check the volume settings. ● Sound muted? Press MUTE button. ● Try another channel. ● Check audio cable connections.
The remote control does not work	<ul style="list-style-type: none"> ● Make sure the remote control is in range with no obstructions. ● Check the batteries. ● Correct operating mode set: TV, VCR etc.
Poor sound or no sound	<ul style="list-style-type: none"> ● Station or Cable TV experiencing problems, tune to another station. ● Check sound adjustments (Volume or Mute). ● Check for sources of possible interference.
Poor picture or no picture	<ul style="list-style-type: none"> ● Station or Cable TV experiencing problems, tune to another station. ● Make sure channels are set into memory. ● Check antenna or Cable TV connections, adjust antenna. ● Check for sources of possible interference. ● Check picture control adjustments.
Poor TV reception	<ul style="list-style-type: none"> ● Ensure the antenna amplifier is turned on for Antenna TV. ● Adjust the antenna position to a stronger signal receiving angle. ● Check the Antenna connection is tight to the TV. ● Check there is power supplied to the Antenna distribution box. ● Confirm your incoming cable is connected to the correct cable / antenna wall connection inside the RV. ● Ensure the internal RV coax jump cable is connected to the correct port.
Poor Cable / Satellite TV Reception	<ul style="list-style-type: none"> ● Ensure antenna amp is turned off for cable signal. ● Check incoming Cable is connected correctly to RV. ● Ensure cable splitter box has power. ● Confirm the incoming cable is connected to the correct cable / Satellite wall connection inside your RV. ● Ensure the internal RV coax jump cable is connected to the correct port. ● Check Dish has not obstruction.
TV shuts off	<ul style="list-style-type: none"> ● Sleep Timer is set. ● Power interrupted.
TV AV input plays black and white	<ul style="list-style-type: none"> ● Check RCA connections on the back of the TV and from the source to ensure they are connected to the correct connections. Ensure the yellow connection is in the correct port.

Specifications

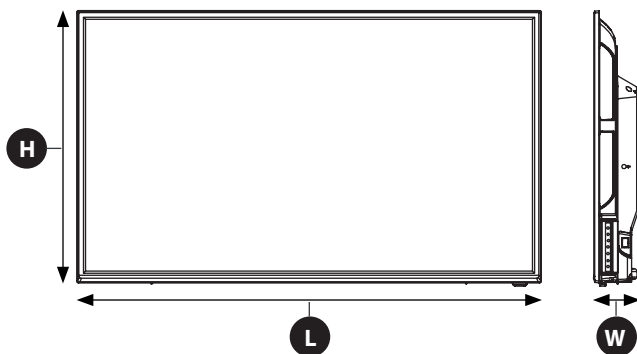

MODEL, DIMENSION & RESOLUTION

TV Model	Dimension (mm) (L*H*W)			Max Resolution
FEHD19S0A	456	295	47	1366 x 768 @ 60Hz HD
FEFD22S0A	534	342	50	1920 x 1080 @ 60Hz FHD

INPUT & OUTPUT CONNECTIONS

TV Model	HDMI in	VGA (PC) in	Audio (PC) in	Coaxial Audio Out	Optical Audio Out	USB	Audio Out	Audio in	Component Video in	Component Y _P P _R Video in	Earphones	RF in
FEHD19S0A	1	1	1	1	0	1	1 x Right (Red) 1 x Left (White)	1 x Right (Red) 1 x Left (White)	1 x Yellow/	1 x Green 1 x Blue 1 x Red	1	1
FEFD22S0A	1	1	1	1	0	1	1 x Right (Red) 1 x Left (White)	1 x Right (Red) 1 x Left (White)	1 x Yellow	1 x Green 1 x Blue 1 x Red	1	1

FURRION

Furrion Innovation Center & Institute of Technology

- 52567 Independence Ct., Elkhart, IN 46514, USA ● Toll free:1-888-354-5792
- Email: info@furrion.com

©2007-2018 Furrion Ltd. Furrion® and the Furrion logo are trademarks licensed for use by Furrion Ltd. and registered in the U.S. and other countries.

FURRION.COM